

**EARN!**  
**1ST CUP**  
**PR LEGENDS**



**BMHOLLY**



# 快速入门指南 Quick Start Guide

## STEP1

遥控器安装电池

Install Battery into transmitter

STEP1

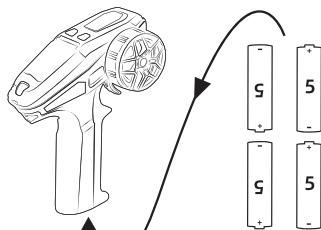

## STEP2

车子电池充电

Charging the battery of car

STEP2

②  
5V 2.1A Type-C



①



Battery

## STEP3

打开遥控器电源

Turn on the transmitter power

STEP3

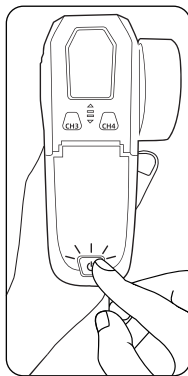

## STEP4

正确安装车子电池

Install the battery on chassis correctly

STEP4-5

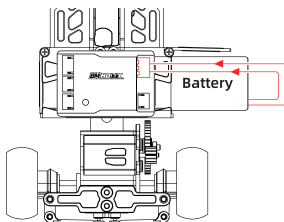

## STEP5

车子通电，确保方向，油门正常

Power on the car, please make sure the steering direction and throttle are normal operation

## STEP6

正确安装车壳

Correctly install the body shell

STEP6

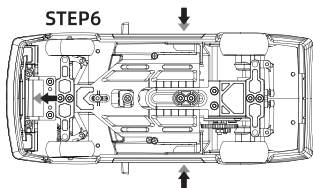

※ 确保卡扣安装到位  
※ Make sure all the buckles are plugged in place

# 快速入门指南 Quick Start Guide

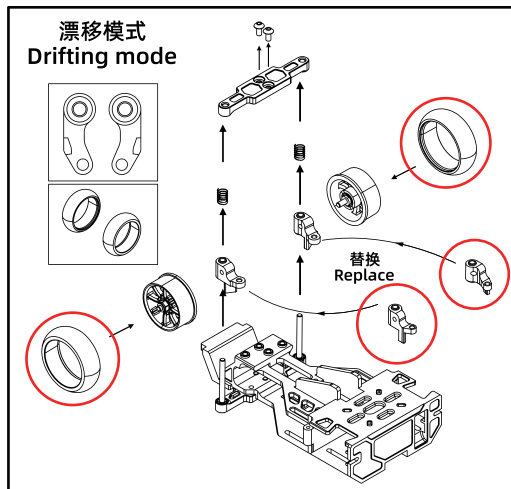
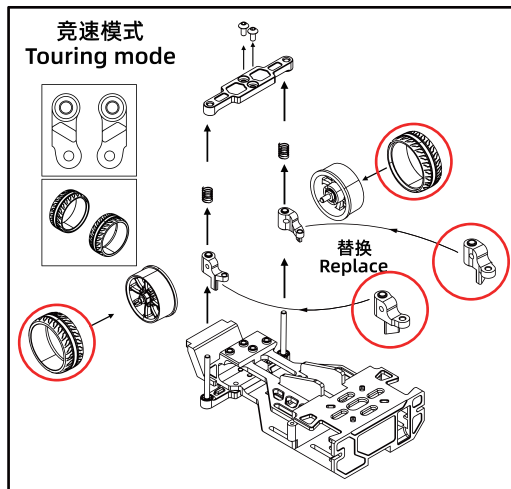

**方向中位(初始0)**  
Direction median (initial 0)

方向大小  
Direction size

**漂移75**      Drifting mode 75

**竞速25-50**    Touring mode 25-50

陀螺仪感度  
Gyro gain

**漂移6-9点位置**  
Drifting mode 6-9 o'clock position

**竞速5-6点位置**  
Touring mode 5-6 o'clock position

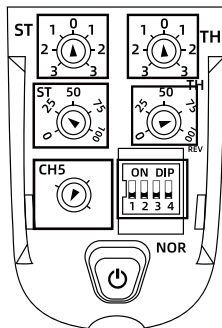

**油门中位(初始0)**  
Throttle neutral position (initial 0)

**油门大小 (初始75)**  
Throttle range (initial 75)

**通道方向切换**  
Channel direction switching

## 组装工具 Assembling Tools



十字螺丝刀 x 1  
Phillips Screwdriver

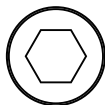

螺母套筒 x 1  
Nut Driver



内六角扳手 x 2  
Hex Wrench  
[ 1.3mm、1.5mm ]



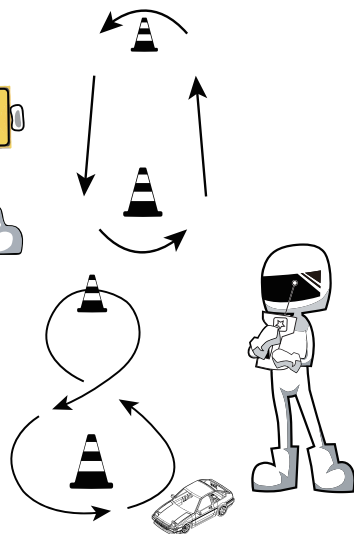
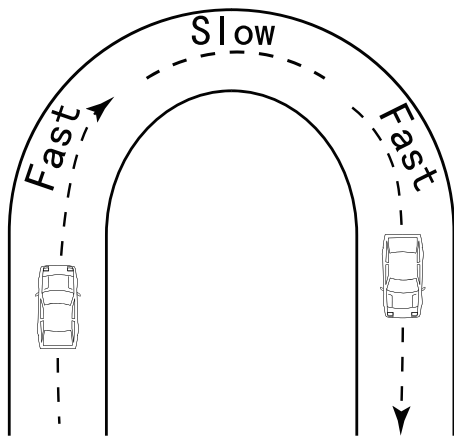

在漂移前请熟练油门和转向配合的操控，  
练习入弯减速和出弯恢复车速。

Before drifting please practice at  
slow down entering a corner and accelerate  
when exiting the corner.

熟练操作后可用障碍物，  
进行定圆和8字的漂移练习。

After practiced the throttle training,  
you can try practice with  
circle drift and figure 8.

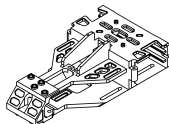

车体 (x 1)  
Main Chassis

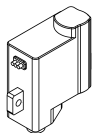

舵机 (x 1)  
Servo



圆头 M2 x 4 (x 21)  
M2 x 4 RH Screw



圆头 M2 x 3 (x 1)  
M2 x 3 RH Screw



M2 x 4 沉头螺丝 (x 2)  
M2 x 4 CS Screw



M1.6 x 4 沉头螺丝 (x 5)  
M1.6 x 4 CS Screw



M2 x 6 沉头螺丝 (x 1)  
M2 x 6 CS Screw



十字螺丝 (x 1)  
Phillips Head Screw



M1.6 x 5 机米 (x 1)  
1.6 x 5 pin



M2 螺母 (x 4)  
Wheel Nut



M2 六角螺母 (x 2)  
Jam Nut

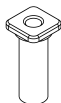

转向组 (x 1)  
Steering Post



4mm摆臂球头 (x4)  
4MM Through Hole Pin Ball

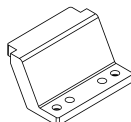

前车壳固定座 (x 1)  
Front Body Mount



舵机保护弹簧 (x 1)  
Steering Spring

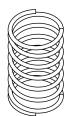

前轮弹簧 (x 2)  
Front Spring

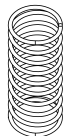

后轮弹簧 (x 2)  
Rear Spring



传动齿 (x 2)  
Idler Gear



马达齿 (x 1)  
Pinion Gear



大齿 (x 1)  
Spur Gear



直轴齿 (x 1)  
Solid Axle Gear



主轴齿 (x 1)  
Main Shaft Gear



3 x 6 x 2 轴承 (x 1)  
3 x 6 x 2 Bearing



3 x 6 x 2.5 轴承 (x 8)  
3 x 6 x 2.5 Bearing



2 x 5 x 2.5 轴承 (x 4)  
2 x 5 x 2.5 Bearing



4 x 7 x 2.5 法兰轴承 (x 2)  
4 x 7 x 2.5 Flange Bearing



2.5 球头胶 (x 2)  
2.5 Ball End Cap

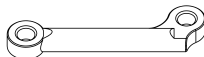

短前拉杆 x 2  
Front Short Tie Rod

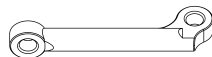

短后拉杆 x 2  
Short Rear Tie Rod



窄前摆臂座 x 2  
Front Narrow Suspension Mount

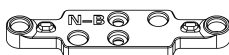

窄后摆臂座 x 2  
Rear Narrow Suspension Mount

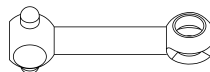

CVD x 2



CVD接杯中连 (x 2)  
CVD Cross Spider



CVD小销 (x 2)  
CVD PIN



CVD接杯 (x 2)  
Rear Axle Shaft



2.5 球头 (x 8)  
2.5 Rod End Ball

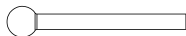

悬挂插销前21mm, 后 24mm (x 4)  
Suspension Pin Front 21mm, Rear 24mm

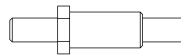

前轮轴 (x 2)  
Front Axle



传动主轴 (x 1)  
Main Shaft



波箱齿轮轴 (x 1)  
Idler Gear Shaft

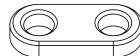

舵机盖板 (x 2)  
Servo Mount Cover



直轴接杯 长 (x 1)  
Solid Axle Drive Cup (Wide)

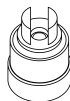

直轴接杯 短 (x 1)  
Solid Axle Drive Cup (Narrow)

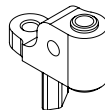

漂移转向杯 R (x1)  
Racing Steering Knuckle (Right)

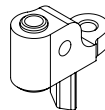

漂移转向杯 L (x1)  
Racing Steering Knuckle (Left)



后杯 R (x 1)  
Rear Hub Carrier (Right)



后杯 L (x 1)  
Rear Hub Carrier (Left)



后结合器 (x 2)  
Rear Wheel Hub



竞速转向杯 R (x1)  
Drift Steering Knuckle (Right)



竞速转向杯 L (x1)  
Drift Steering Knuckle (Left)



漂移窄轮胎 (x 2)  
Narrow Drift Tire



漂移宽轮胎 (x 2)  
Wide Drift Tire



窄轮毂 (x 2)  
Narrow Wheel



宽轮毂 (x 2)  
Wide Wheel



竞速窄轮胎 (x 2)  
Narrow Racing Tire



竞速宽轮胎 (x 2)  
Wide Racing Tire

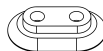

轴距调节固定座 (x 1)  
Wheel Base Adjustment Mount

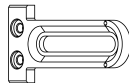

调轴体 (x 1)  
Wheelbase Block

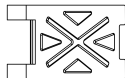

电池固定座 (x 2)  
Battery Mount

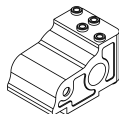

后波箱壳 (x 1)  
Rear Gear Box Case

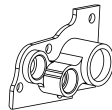

后波箱侧盖 (x 1)  
Rear Gear Box Side Cover

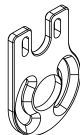

马达座 (x 1)  
Motor Mount



马达 (x 1)  
Brushed Motor

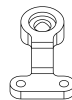

转向摇臂 (x 1)  
Steering Bell Crank

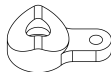

转向组底座 (x 1)  
Steering Base Mount

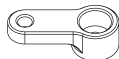

舵机臂 (x 1)  
Servo Horn



3 x 6 x 0.3 垫片 (x 2)  
3 x 6 x 0.3 Spacer

**BMHobby**

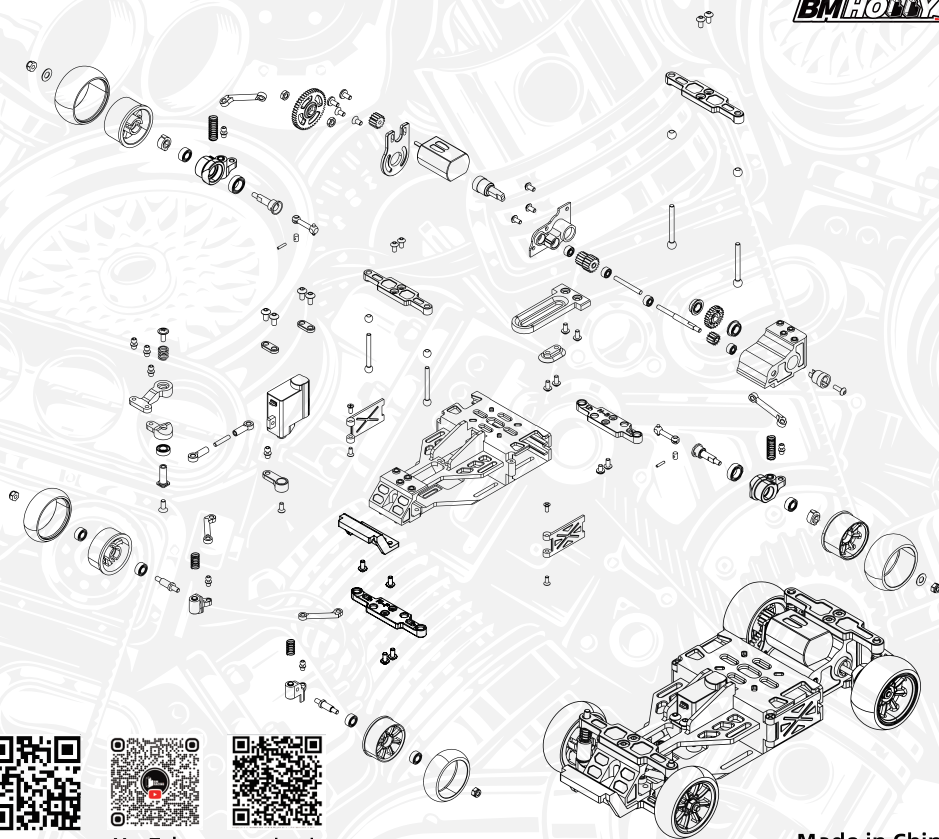

bilibili



YouTube



Facebook

Made in China

## 电池仓尺寸 Battery compartment size

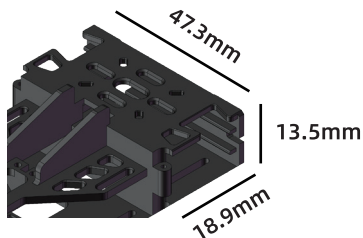

## 轴距尺寸 Wheelbase range

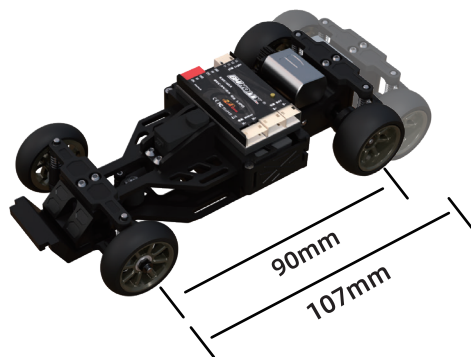

## 轮距尺寸 Track width range

